

Installation:

The device can simply be plugged directly into the vehicle's OBD2 port to install. These are the ports used by service personnel and are generally always easily accessible for the drivers seat as shown below:

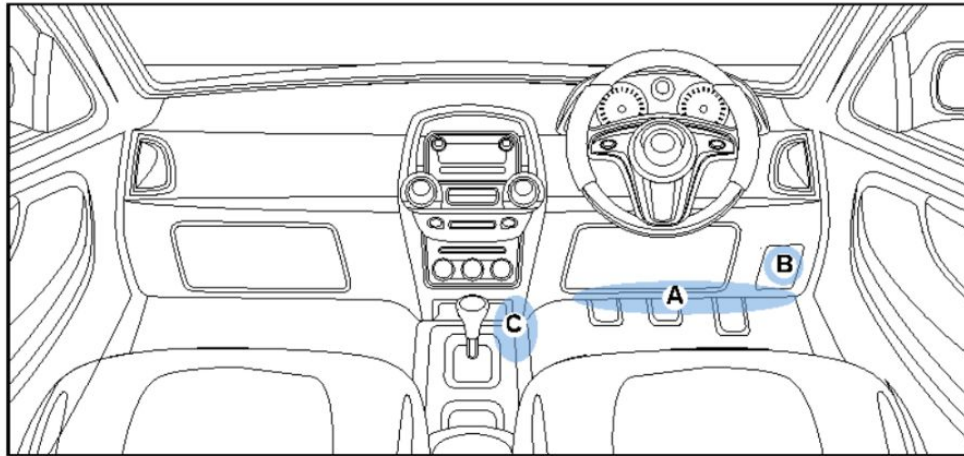

- A. Just under the dash
- B. Behind the fuse cover
- C. In the centre console

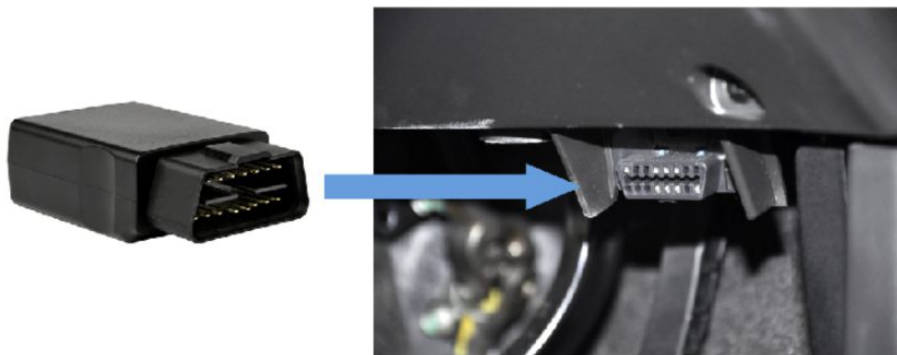

OBD2:

If you are wanting to have the device concealed behind the dash, or if the OBD2 port is in a position that does not easily for the device to be plugged in, you can use the 3 way-adaptor supplied as per the instructions below:

1. Remove vehicle OBD port from the dash

Squeeze the pins on the left and right that secure the plug into the dash and push.

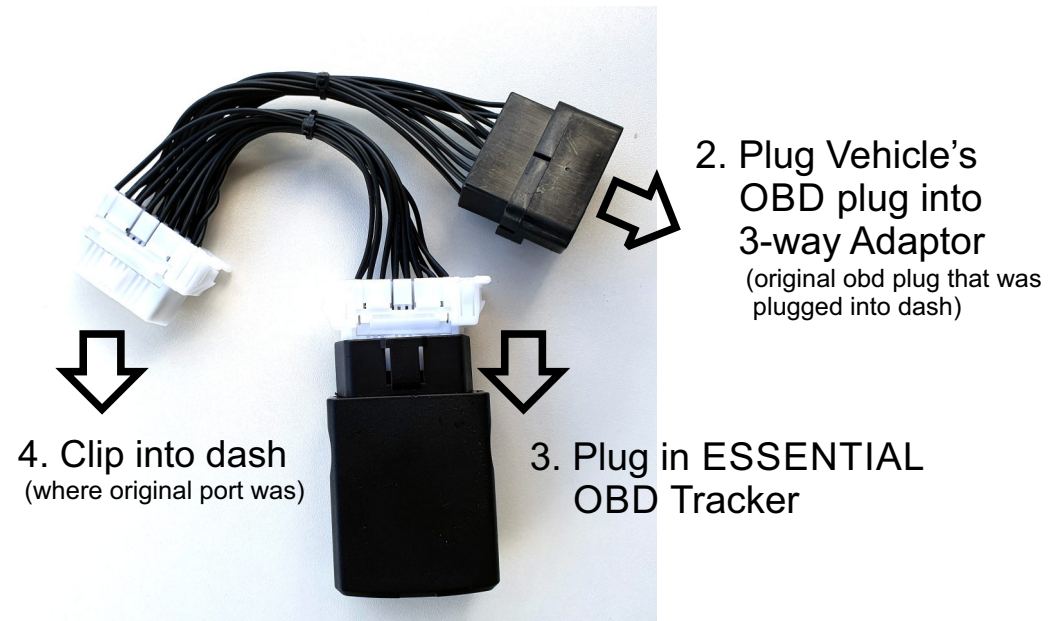

It is important to cable-tie or tape up the excess wires under the dash and to firmly secure the GPS to the

if you are having any difficulties or require different adaptors due to the position of the port please email: support@gpslogbook.co.nz

Test the installation:

Visit www.oemserver.com/installer and enter the serial number to test the device.

Ensure that the vehicle has GSM coverage and is outdoors with sight of the sky for testing.



Understanding Installer Test Results



The installer test website will check the device's most recent behaviour.

The important items to look for are:

- Last Communication
- Last Commit
- Last GPS Update

If your results look like "A" ensure the vehicle has a clear view of the sky and is in range of cellular network. Ensure the device is plugged in. **Conduct a test trip.**

If your results look like "B" ensure the vehicle has a clear view of the sky and is in range of cellular network. Ensure the device is plugged in. **Conduct a test trip.**

If your results look like "C" the device is installed correctly.

Result A	Result B	Result C
<p>Device Serial Number: 123456</p> <p>Device Type: Dart</p> <p>Last Communication ✗ NEVER 161 days ago (07 Apr 2016 16:11:40 UTC)</p> <p>Last Commit ✗ NEVER 161 days ago (07 Apr 2016 16:11:40 UTC)</p> <p>Last GPS Update ✗ NEVER Never</p> <p>Battery Level ✓ 3.729 V</p> <p>External Power ✓ 11.8 V</p> <p>Digital Inputs Ignition: Off ✗ DI 1: Off ✗ DI 2: Off ✗ DI 3: Off ✗ DI 4: Off ✗</p> <p>Enabled ✓ Yes</p> <p>Firmware ✓ 1.4</p> <p>Parameters ✓ Okay</p> <p>Conduct a test trip</p>	<p>Device Serial Number: 123456</p> <p>Device Type: Remora</p> <p>Last Communication ✗ RECENT 5 hr 38 min ago (15 Sep 2016 16:42:56 UTC)</p> <p>Last Commit ✗ RECENT 5 hr 38 min ago (15 Sep 2016 16:42:56 UTC)</p> <p>Last GPS Update ✗ RECENT 17 hr 38 min ago (15 Sep 2016 04:42:34 UTC)</p> <p>Battery Level ✓ 5.954 V</p> <p>External Power ✗ 0 V</p> <p>Digital Inputs Ignition: Off ✗ DI 1: On ✓ DI 2: Off ✗ DI 3: Off ✗ DI 4: Off ✗</p> <p>Enabled ✓ Yes</p> <p>Firmware ✓ 1.23</p> <p>Parameters ✓ Okay</p> <p>Conduct a test trip</p>	<p>Device Serial Number: 123456</p> <p>Device Type: Dart</p> <p>Last Communication ✓ RECENT 8 mins ago (15 Sep 2016 22:14:07 UTC)</p> <p>Last Commit ✓ RECENT 8 mins ago (15 Sep 2016 22:14:07 UTC)</p> <p>Last GPS Update ✗ RECENT 1 days 17 hr ago (14 Sep 2016 04:54:48 UTC)</p> <p>Battery Level ✓ 4.187 V</p> <p>External Power ✓ 12.26 V</p> <p>Digital Inputs Ignition: Off ✗ DI 1: Off ✗ DI 2: Off ✗ DI 3: Off ✗ DI 4: Off ✗</p> <p>Enabled ✓ Yes</p> <p>Firmware ✓ 1.4</p> <p>Parameters ✓ Okay</p> <p>Connector ✓ Okay</p> <p>INSTALLATION SUCCESSFUL</p>

Next visit gpslivetrack.co.nz/activate to request device activation.

Enjoy your tracking!

SUPPORT ASSISTANCE NZ: 0800 477564 / 0800 GPSLOG